

VARIABLE SKEW ANGLE BRACKET

FEATURES AND BENEFITS

EASY: Simple design.

FAST: Fixed with Pryda 12 x 35mm screws.

VERSATILE: Can be used in a 'horizontal' orientation as an angle seat to support beams or trusses coming in at any direction, or in a 'vertical' orientation as an angle cleat for beam to beam connections.

SPECIFICATIONS

PRODUCT CODE	LVSIA
STEEL	G300
THICKNESS	5mm
CORROSION RESISTANCE	Hot Dipped Galvanised Steel
FASTENERS REQUIRED	Pryda 12G x 35mm Screws (TCS12-35) 1 x No.10x30mm Type 17 screw required for uplift capacity if using bracket as a seat
QUANTITY	10

Strong and versatile bracket that can be used as a seat or cleat for beams.



AS1684 & AS1720 COMPLIANT

- More than the minimum Z275 galvanised steel
- Design values tested in accordance to the relevant standard

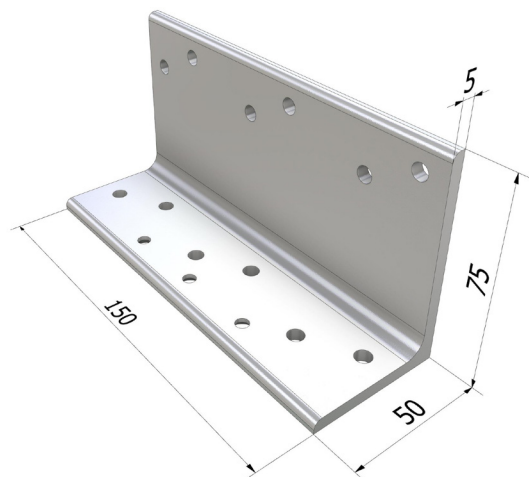
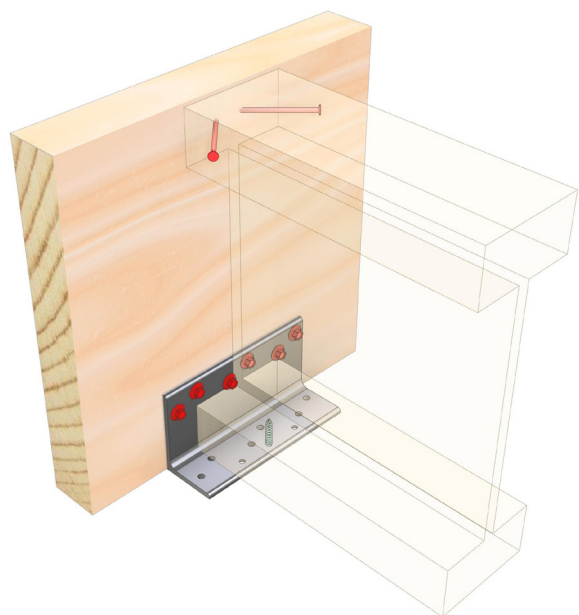

DESIGN CAPACITIES

VERTICAL SINGLE CLEAT

Fixings – 6/Pryda TCS12-35 screws on each leg.

JOINT GROUP	SINGLE LVZIA AS AN ANGLE CLEAT FOR GIVEN LOAD CASES			
	1.35G	1.2G+1.5QF	1.2G+1.5QR	WIND UPLIFT
JD4	4.8	5.8	6.4	8.6
JD3 (1)	6.7	8.0	9.0	13.3

Fixing to **Supported Beam** : 6 screws in to 75mm leg
 Fixing to **Supporting Beam** : 6 screws in to 50mm leg

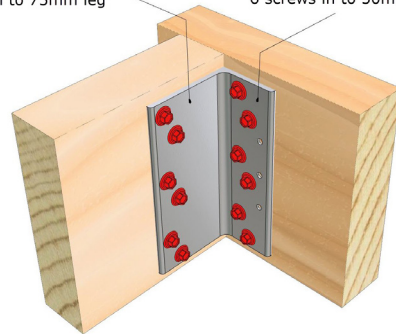

NOTES:

1. Provide 2/No.14 x 90 Type 17 screws from the back of supporting beam in to end-grain of supported beam to resist twisting of supporting beam. Use longer screw lengths if required to ensure a minimum 35mm penetration.
2. When the supported member used is prone to splitting (like hardwoods-JD3), additional precautions should be taken. These can be in the form of prebored holes or provision of anti-split nailplates at ends of the supported beam.
3. Screws with longer lengths are required when LVZIA brackets are fixed into multiple laminated beams. For double laminates, use Pryda 65mm long screws per flange.
4. If the bracket is used as a PAIR, the given capacities shall be increased by a factor of 2.5. Ensure the screws on supporting beam are at least 30mm from end grain.

SEAT HANGER

Fixings – 6/Pryda TCS12-35 screws on vertical leg and 1/No.10x30 Type 17 counter-sunk screw on horizontal leg.

JOINT GROUP	LOAD CAPACITIES(KN) FOR LVZIA AS AN ANGLE SEAT FOR GIVEN LOAD CASES			
	1.35G	1.2G+1.5QF	1.2G+1.5QR	WIND UPLIFT
JD5	4.8	5.8	6.5	1
JD4	6.7	8.2	9.1	1.4
JD3	9.5	11.5	12.9	1.8

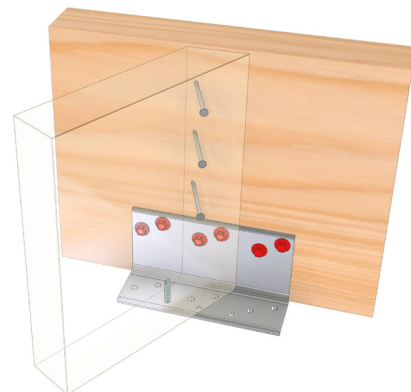

NOTES:

1. The supported beam must be laterally tied to prevent rotation.

IMPORTANT:

READ THIS DATASHEET IN CONJUNCTION WITH PRYDA HANGERS & TRUSS BOOTS DESIGN GUIDE AND REFER TO ESSENTIAL NOTES AND GENERAL NOTES.