

PRYDA HITCH

FEATURES AND BENEFITS

VERSATILE: Pryda Hitch has built in slots which allow for vertical movement in the truss over time without transferring load to the wall.

These slots cater for some vertical movement of the wall due to foundation settlement, without inducing forces on the truss.

SPECIFICATIONS

PRODUCT CODE	MPPHH (Coined)* PHL (Plain)
STEEL	G300-Z275
QUANTITY	MPPHH - 200 per carton - Merchant pack - 100 PHL - 100 per carton
THICKNESS	MPPHH - 0.8 mm PHL - 1.2 mm

Bracket which stabilises internal, non-load bearing walls from bottom chords of trusses.

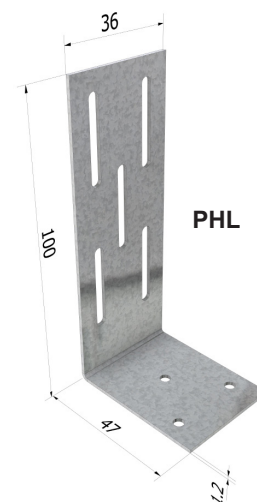
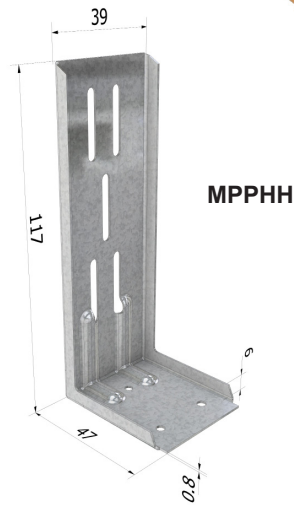
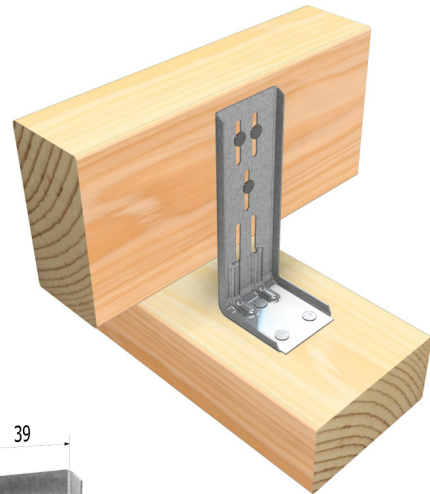

PRODUCT CODE	MATERIAL	TYPE	SIZE	QUANTITY
MPPHH	Galvanised Steel	Flat Head	114 x 46 x 38 x 0.8mm	200
PHL			100 x 44 x 36 x 1.2mm	100

APPLICATION

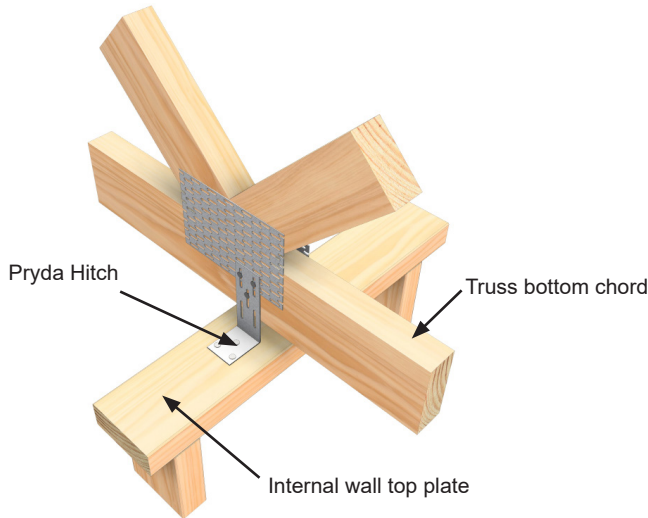

Wall at Right Angles to Trusses

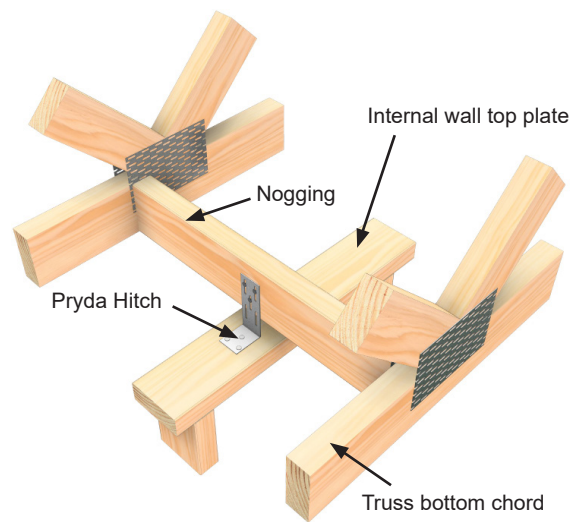

Wall Parallel to Trusses

INSTALLATION

Place the Pryda Hitch alongside the truss bottom chord and fix with 35x3.15 mm galvanised Pryda Timber Connector Nails to the top plate of the wall, then nail through the slots into the truss bottom chord. For truss cambers not exceeding 10mm (for MPPHH) or 15mm (for PHL), the nail shall be located midway in the slot. This would also cater for vertical movement of walls due to foundation settlement in reactive clays. However, for larger truss cambers, the nail shall be located near the top of the slot. Care must be taken not to drive the nails fully home which would restrict vertical movement of the truss.

Extra slots are provided for additional nailing if required. Fixing as described locates the partition framing yet permits the truss to settle without loading a non-load bearing wall or partition. Fix at every second truss or at 1800 mm intervals.

NAILING REQUIREMENTS

CODE	NAILING REQUIREMENTS
MPPHH	2@ 35 x 3.15mm Pryda Nails to bottom chord 3@ 35 x 3.15mm Pryda Nails to top plate
PHL	2@35 x 3.15mm Pryda Nails to bottom chord 3@35 x 3.15mm Pryda Nails to top plate

IMPORTANT:

READ THIS DATASHEET IN CONJUNCTION WITH PRYDA CONNECTORS & TIE-DOWN CONNECTORS DESIGN GUIDE AND REFER TO ESSENTIAL NOTES AND GENERAL NOTES.

INSTALLATION

STEP 1



- Place the Pryda Hitch alongside the truss bottom chord and fix with 35x3.15 mm galvanised Pryda Timber Connector Nails to the top plate of the wall, then nail through the slots into the truss bottom chord. Care must be taken not to drive the nails fully home which would restrict vertical movement of the truss.

STEP 2

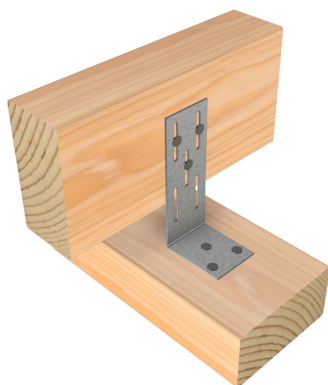

- For truss cambers not exceeding 10mm (for MPPHH) or 15mm (for PHL), the nail shall be located midway in the slot. This caters for some vertical movement of walls due to foundation settlement in reactive clays.

STEP 3



- For larger truss cambers, the nail shall be located near the top of the slot.
- Note: For girder-to-girder connections where cumulative truss deflection can occur, the brackets may need to be re-nailed after the roof has been loaded. The nail location on the slots should be checked after loading the roof.



LOOKING FOR MORE DETAILS OR OTHER CONNECTORS IN OUR RANGE?

SEE OUR CONNECTORS & TIE-DOWN CONNECTORS DESIGN GUIDE AVAILABLE AT [PRYDA.COM.AU](https://www.pryda.com.au)