

pryda

FAST FIX

**INTRODUCING THE
INTERNAL
WALL SCREW**

The FastFix™ Internal Wall Screw (IWS) takes the time and labour out of tedious L Bracket connections, and replaces it with smart thinking, saving you money with a fast, compliant connection.



JUST PLAIN EASIER

**SMARTER CONNECTION - MORE PRECISE
THAN A CONVENTIONAL L BRACKET**



**ONE-PIECE FIXING - FOR SIMPLE
AND EASY INSTALLATION PROCESS**



NO HAND HAMMERING



**FAST, SAFE, ERROR FREE CONNECTION
- CANNOT BE OVERDRIVEN**



**LESS TIME WORKING AT HEIGHTS
- INSTALLED FROM UNDER THE TOP PLATE**



**A JOB THAT USED TO TAKE HOURS
IS NOW COMPLETE IN MINUTES**

ONE PIECE FIXING ALLOWS FOR SIMPLE AND EASY INSTALLATION – NO NAILS

125mm in length



Fast start
drill point

Pronounced knurl that
lessens any splitting

5mm hex head
for easy install

PRODUCT OVERVIEW

The IWS laterally stabilises the tops of internal walls by fixing them to the bottom chord of roof trusses.

The IWS has a knurled shank which ensures the screw is firm laterally against the top plate. The head-less plain shank of the screw in the top plate allows for vertical movement in the truss without transferring load to the wall.

The product is suitable for internal applications only.

Tooling required:

- Cordless impact driver or equivalent.
- 5mm nut setter or 5mm socket and hex drive adapter.

PRODUCT SPECIFICATION

SCREW STEEL GRADE

AISI 1022 grade steel

SCREW CORROSION PROTECTION

Electroplated zinc coating as per AS 1789 – 2003

SCREW SIZE

M8 x 125mm with 5mm Internal Hex Drive

PRODUCT CODE

IWS

pryda

FAST FIX

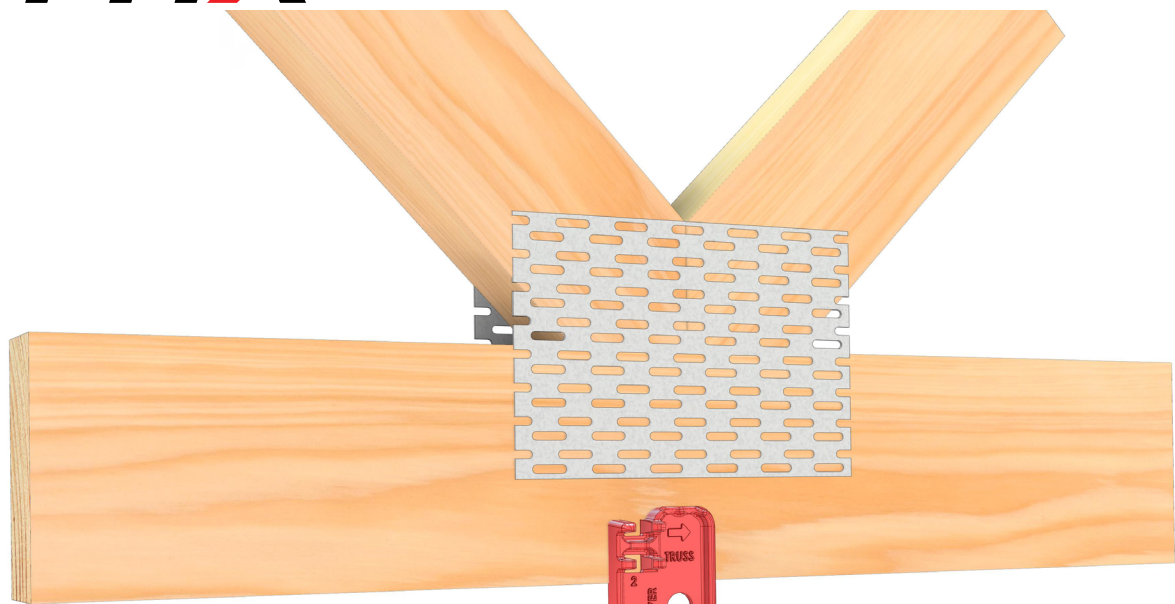

**LINES UP PERFECTLY,
EVERY TIME**

**SCREW LOCATES EASILY
SO IT'S ALWAYS CENTRED**

When installed with the Pryda IWS Guide, it's a quick process – place the guide, position the drill, remove the guide and drive the screw home.

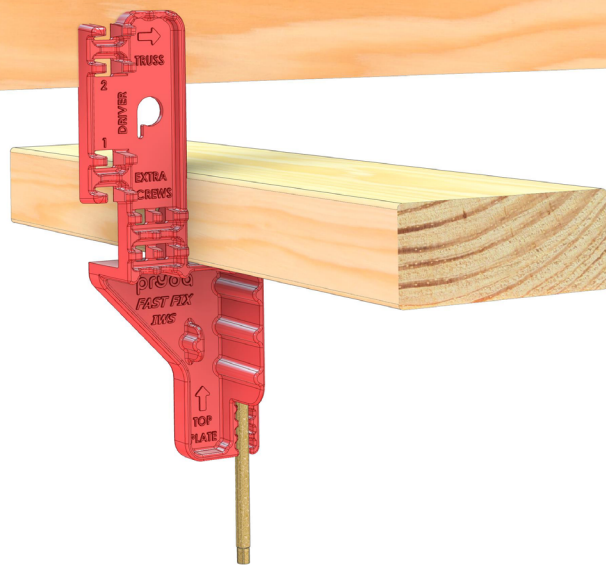

IWS guides are sold separately.

Product code: IWSGN

INSTALLATION INSTRUCTIONS

STEP 1



Place the 5mm nutsetter (included in the guide pack) into your drill or impact driver.

STEP 2



Take an Internal Wall Screw and place it in the slot on the guide. Using the guide will ensure the screw is positioned in the correct location.

STEP 3



Place the guide to the underside of the wall frame and move the guide until it's resting up against the roof truss. Drive the screw until the nutsetter meets the guide.

STEP 4



Remove the guide once the nutsetter meets the guide and drive the screw home.

Scan the QRcode to watch
the installation video



pryda
FAST FIX

Available only from Pryda Fabricators.

Patents applied for.

**SAFER.
FASTER.
SMARTER.
EASIER.**

**1300 657 052 (AUS)
PRYDA.COM.AU**

Scan the QR code to
view the product page

